



5.5A GENESIS GENERATION PUMP

NEMA CORD		NEMA CORD & AIR SWITCH	
Part No.	Bulk Qty.	Part No.	Bulk Qty.
321FF10-0101	18	321FF10-0150	18
321FF10-1101	1	321FF10-1150	1



7.5A GENESIS GENERATION PUMP

NEMA CORD		NEMA CORD & AIR SWITCH	
Part No.	Bulk Qty.	Part No.	Bulk Qty.
321HF10-0101	18	321HF10-0150	18
321HF10-1101	1	321HF10-1150	1



9.5A GENESIS GENERATION PUMP

NEMA CORD		NEMA CORD & AIR SWITCH	
Part No.	Bulk Qty.	Part No.	Bulk Qty.
321JF10-0101	18	321JF10-0150	18
321JF10-1101	1	321JF10-1150	1



13.5A GENESIS GENERATION PUMP (1 ½" SUCTION)

NEMA CORD		NEMA CORD & AIR SWITCH	
Part No.	Bulk Qty.	Part No.	Bulk Qty.
321NF10-0101	18	321NF10-0150	18
321NF10-1101	1	321NF10-1150	1

13.5A GENESIS GENERATION PUMP (2" SUCTION)

NEMA CORD		NEMA CORD & AIR SWITCH	
Part No.	Bulk Qty.	Part No.	Bulk Qty.
321NF10-0B01	18	321NF10-0B50	18
321NF10-1B01	1	321NF10-1B50	1



672-1170

ANTI-VIBRATION PADS
(3 REQUIRED & INCLUDED W/ PUMP)

Part No.	Bulk Qty.
672-1170	144



400-3145

**1" S 45° LOW PRO
UNION WYE ASSEMBLY**

Part No.	Bulk Qty.
400-3145	25



400-4200

**1" S LOW PRO
UNION TEE ASSEMBLY**

Part No.	Bulk Qty.
400-4200	25



400-4250

**1" SB UNION TEE
ASSEMBLY (26mm)**

Part No.	Bulk Qty.
400-4250	30



400-4190

**1" SPG LOW PRO
UNION TEE ASSEMBLY**

Part No.	Bulk Qty.
400-4190	25



400-3800

**1.5" 65° ELL UNION
ASSEMBLY**

Part No.	Bulk Qty.
400-3800	36



400-4740

**1.5" S LOW PRO
UNION TEE ASSEMBLY**

Part No.	Bulk Qty.
400-4740	25



400-4060

1.5" S UNION ASSEMBLY

Part No.	Bulk Qty.
400-4060	200



400-4730

**1.5" SPG LOW PRO
UNION TEE ASSEMBLY**

Part No.	Bulk Qty.
400-4730	25



400-5570

2" S UNION ASSEMBLY

Part No.	Bulk Qty.
400-5570	140

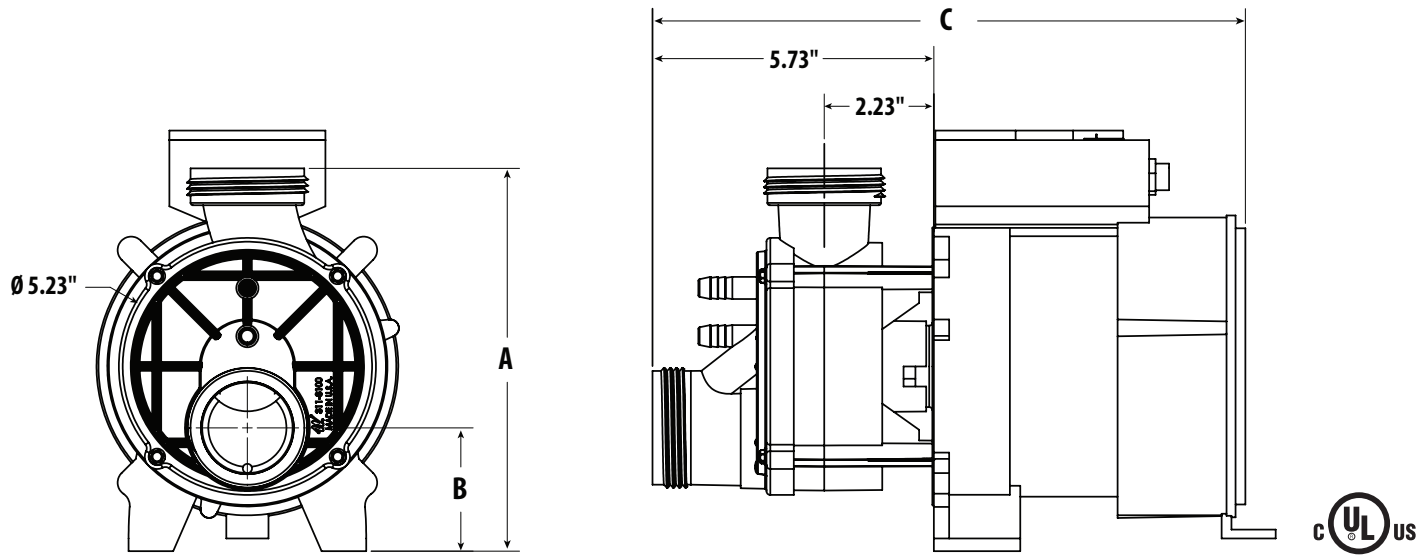

GENESIS GENERATION PUMP SPECIFICATIONS

Part No.	Description	Volts	Hz	Amps	"A"	"A" w/ Pads	"B"	"C"
321FF10-xxxx	5.5 Amp with NEMA Cord & Air Switch	115 V	60	5.5	7.10"	7.475"	1.82"	10.78"
321HF10-xxxx	7.5 Amp with NEMA Cord & Air Switch	115 V	60	7.5	6.69"	7.065"	1.41"	11.72"
321JF10-xxxx	9.5 Amp with NEMA Cord & Air Switch	115 V	60	9.5	7.79"	8.165"	2.51"	12.07"
321JN10-xxxx	13.5 Amp with NEMA Cord & Air Switch	115 V	60	13.5	7.79"	8.165"	2.51"	12.82"

Genesis Generation Bath Pumps - Performance Curves

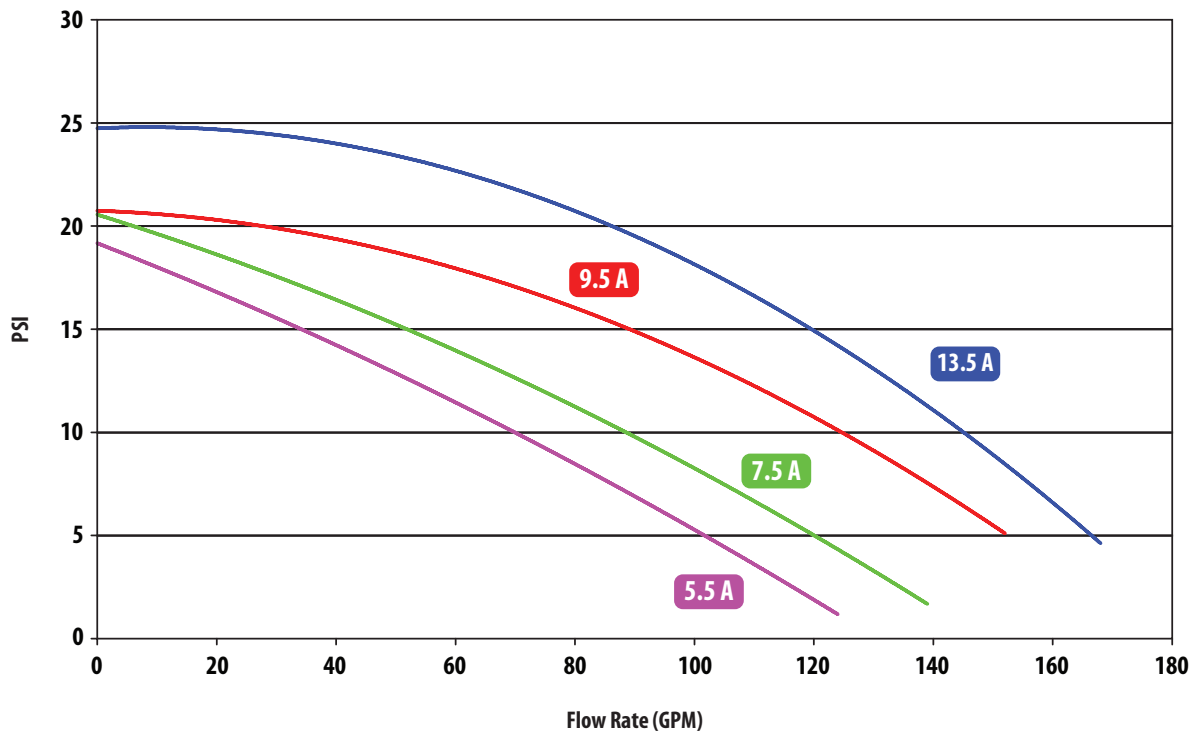



Waterway Whirlpool Bath Pump Warranty

Genesis Generation Whirlpool Bath pumps are warranted to be free of defects in workmanship and materials for a period of 24 months from the date of motor manufacture (pump seals warranty for 12 months, only replacement seals will be sent).

Merchandise damaged as a result of carelessness, improper handling, rodents, insects (termite) or misapplication is specifically excluded from this warranty.

If within the warranty period, any such products shall prove defective, it shall be repaired or replaced at Waterway's option as follows:

1. The original retail purchaser shall first contact the point of purchase or the installing dealer, as soon as possible after discovery of the defect, but in no event later than the expiration date of this warranty. Processing of warranty claims should be initiated by the point of purchase or the installing dealer.
2. A Return Good Authorization (RGA) form must be completed and submitted to Waterway by the point of purchase or the installing dealer or OEM.
3. Waterway will issue an RGA for eligible items that are not out of their warranty period.
4. Waterway will advise the address to which the defective items may be shipped. The customer must pay for all shipping charges (no product shall be returned to Waterway without prior consent).
5. After receipt of the products, supporting documents and verification of the nature and cause of the defect, Waterway will replace or repair the defective products or issue warranty credit for eligible items at Waterway's option.

In no event shall Waterway be liable for labor or material charges in connection with removal or replacement of the defective products. Waterway is not liable for incidental or consequential damages, loss of profit, loss of time, inconvenience and incidental expenses.

This warranty is limited and shall be in lieu of any other warranties, expressed or implied, including but not limited to, any implied warranty or merchantability or fitness for a particular purpose. There are no other warranties that extend beyond the description of the face hereof. The liability of Waterway arising out of its supply of said products, or their use, shall not in any case exceed the cost of correcting defects in the products as above set forth.

Although Waterway Plastics provides all information, recommendation, or advice regarding its products in good faith, each user bears full responsibility for making its own determination as to suitability of Waterway's products, recommendations, or advice for its own particular use. Each user must identify and perform all tests and analysis necessary to assure that its finished products incorporating Waterway's parts or products will be safe and suitable for use under end-use conditions. This includes but not limited to verification of exposure to ambient operating conditions, adhesives, foams and any other type chemicals during the assembly or the end use conditions. Due to environmental conditions out of our control, we are unable to warranty discolorations or corrosion on stainless steel parts.

This warranty does not apply if the failure is caused or contributed to by any of the following: improper handling, improper storage, improper installation, abuse, unsuitable application of the product, lack of reasonable and necessary maintenance, improper packaging for return, or repairs made or attempted by any other company, which in the judgment of Waterway adversely affects the product's performance and reliability. Waterway reserves the right to change its warranty at any time.

Some states do not allow the exclusion or limitation of incidental or consequential damages, so the above limitation or exclusion may not apply to you. This warranty gives you specific legal rights, and you may also have other rights, which vary from state to state.

For the complete Waterway Limited Warranty, please see page iii.